

PUMPKIN PATCH.

MQG - Block Lotto for October, 2024.

Use your orange fabrics (*good quality fabrics*).
Use white (Kona snow) for the edges.



Pumpkin:

1. Press and trim your orange fabric scraps.
2. Stitch these together into a large block. It may be strips stitched together or more improv.
(*Hint - press often.*)
Size of pumpkin - 9" - 11" before borders.

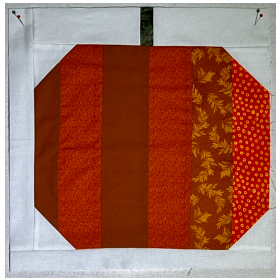
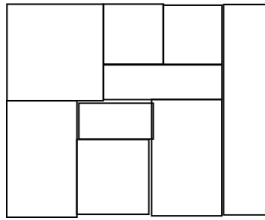
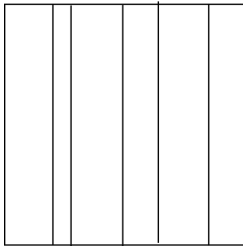

Snowball technique:

1. Cut four squares 2" each, of Kona white.
2. Mark the diagonal on each. Use a pencil or press a crease.
3. Position one square on each corner of your pumpkin and stitch on the diagonal line.
4. Press the seam toward the pumpkin and trim the excess behind to 1/4".

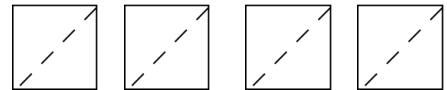

Borders and Stem:

1. Cut a strip of Kona white 2" wide and the length of pumpkin block. Cut this in half. Insert a 1" - 1 1/2" piece of brown stem. Press seams toward the stem.
2. Stitch this to the upper edge of the pumpkin block. Press and trim.
3. Add borders of Kona white to the other 2 or 3 sides. These should vary in width so the pumpkin is off centre. If your pumpkin is large, leave one side without a white strip. This way the finished quilt will have a more random 'pumpkin patch' look.
4. Press seams toward Pumpkin. Trim your block to the finished size of 12 1/2".

1 block = 1 ticket